



iSED® Automated Erythrocyte Sedimentation Rate Analyzer

Manual Bleaching Procedure, 112-28-003 Rev. 0

Purpose

This procedure describes how to perform a manual Bleach Cleaning of the hydraulic system in the event of a dried blood blockage or when frequent Tail Sensor Calibration errors occur in the iSED Automated ESR Analyzer.

Scope

This document describes the procedure to be followed when the tubing system of the iSED needs cleaning with bleach solution, as directed by ALCOR Tech Support, or when the criteria for cleaning is met as described in the iSED Service Manual.

Materials:

1. Empty, unused 13 x 75 blood collection tubes with pierceable cap, with or without EDTA
2. Bleach (6% hypochlorite), diluted with deionized water
3. iWASH™ with enough fluid for minimum of 6 washes
4. Timer set to 5 minutes

Preparation:

Remove cap of blood collection tube and fill with Bleach (6% hypochlorite) to the tube maximum fill line with a minimum of 4.0mL. **Replace Tube Cap**

Procedure:

1. Perform three washes by pressing the Washing icon highlighted in red in Figure 1.
2. Once the three wash cycles have completed press the Service icon highlighted in red in Figure 2. Enter passcode 19912 then press the green check mark.

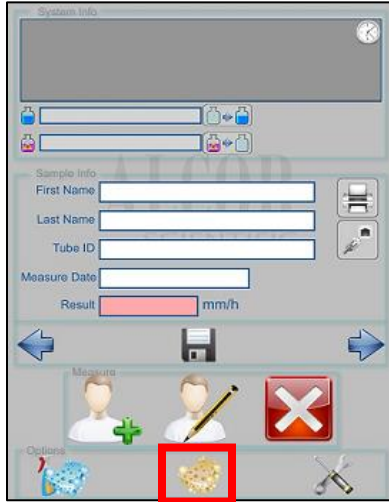

Figure 1

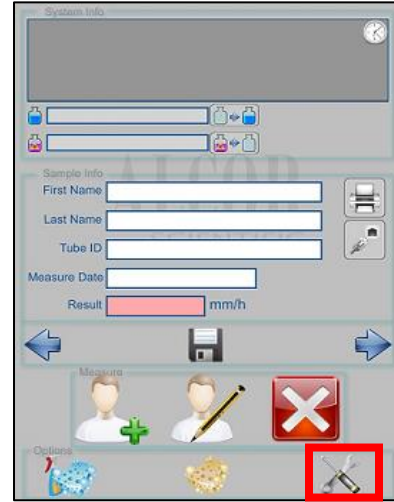

Figure 2

3. Press the reset rotor button as highlighted in red in Figure 3. Once the rotor stops insert bleach tube.
4. Press the Withdrawal Position icon highlighted in red in Figure 4. When the keyboard is displayed enter the value of 1 and press the green check mark.

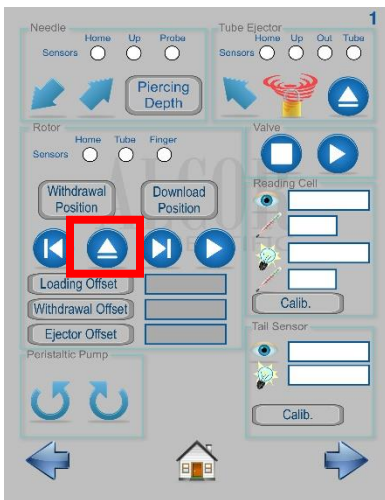

Figure 3

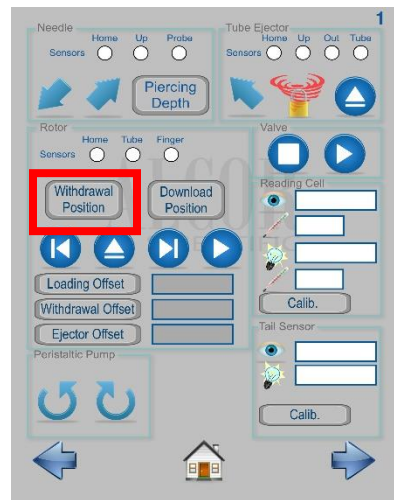

Figure 4

5. Press the “Needle Up” icon highlighted in red in Figure 5 This will cause the Needle to pierce the patient sample tube.
6. Press the Peristaltic Pump “Forward” icon shown highlighted in red in Figure 6. Press this button 8 times waiting a second between each time the button is pressed. This will withdraw the bleach from the sample tube.
7. Set timer for 5 minutes

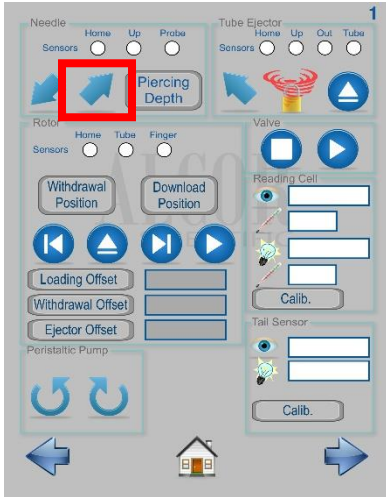

Figure 5

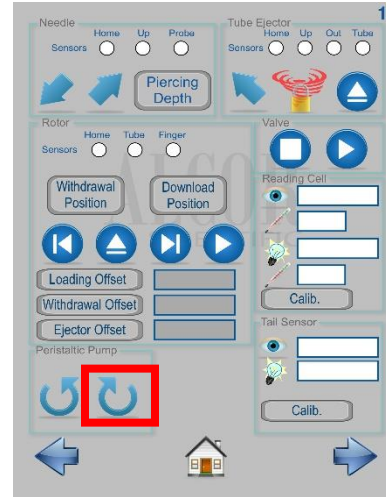

Figure 6

8. Once timer alarms press the “Needle Down” icon highlighted in red in Figure 7.
9. Press the reset rotor button highlighted in red in Figure 8. This will return the bleach tube to the loading position. At this point the tube can be removed and discarded.

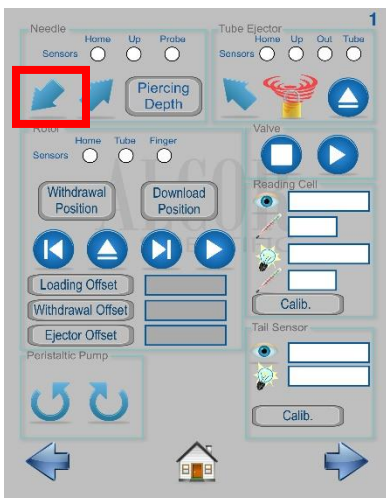

Figure 7

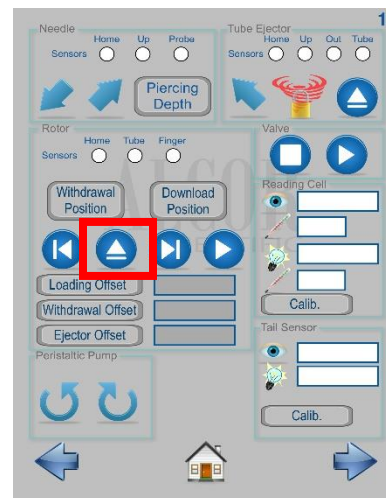

Figure 8

10. Press the Home icon highlighted in red in Figure 9 to return to the main page.

11. Perform three wash cycles by pressing Washing icon in figure 10

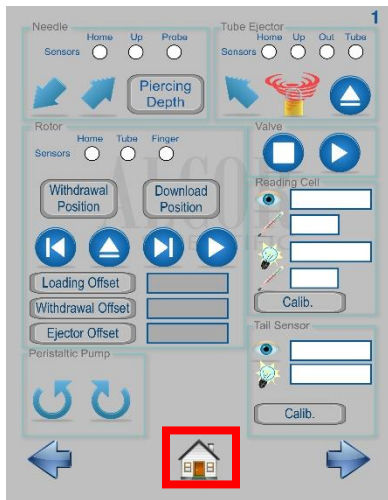

Figure 9



Figure 10

12. Verify that all three washes were completed without any errors. If any errors occur, contact Alcor Scientific Technical Service at 1-800-495-5270 for additional assistance.